

Renata

Electric, Horizontal & Vertical

Fitting Instructions



Please read these instructions and terms and conditions carefully prior to installation. Failure to do so may invalidate the warranty.

Drawings

Fig 1

Brackets & clamps

Horizontal and vertical brackets are the same, though fitted in different orientations

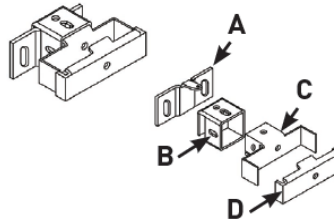

Fig 2

Horizontal

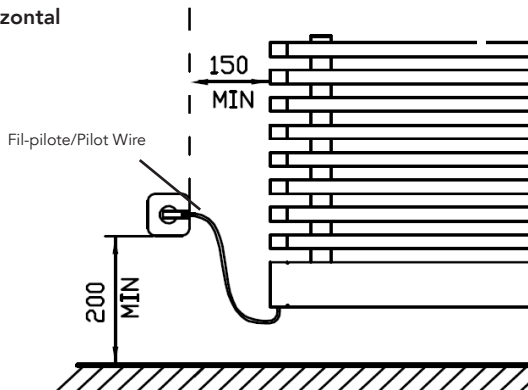
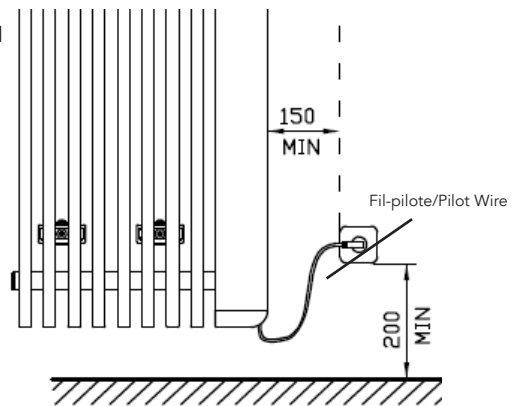

Fig 3

Vertical



1. Unpack & Inspect

This product should have reached you in perfect condition. Please carefully unpack and inspect this radiator and all fittings. Your point of purchase must be notified of any shortages or damage within 28 days of delivery. For further information please see terms and conditions on reverse.

2. Contents

You should have:

- 1 x Radiator
- 4 x Brackets (C & D) with screws
- 4 x Bracket sleeves (B) with screws
- 4 x Wall plates (A)

You will need:

- Tape measure
- Electric drill and bits
- Spirit level
- Appropriate wall fixings

3. Fix Brackets to Radiator

Brackets are fixed as per Fig. 4. Loosely screw part C and D together with the long screw provided.

Push part D through the 2nd and 3rd rear elements as close to the collector as possible. Twist part D so it clamps the elements. Tighten the screw. Fit the bracket sleeve (B) to the brackets with **(NB) the hooks facing downwards** and fasten with short screw provided.

Fig 4

Horizontal

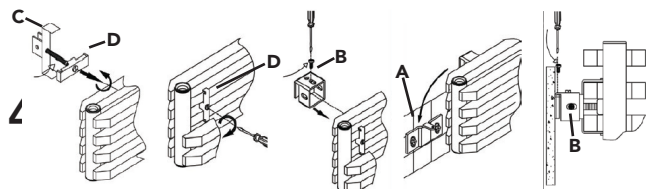
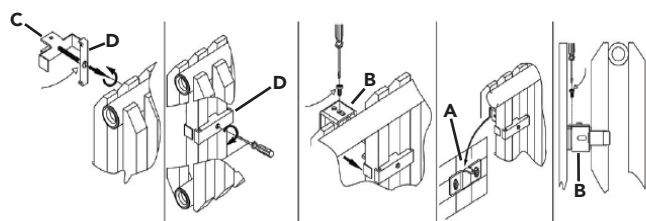

Fig 4

Vertical



4. Mark Bracket Positions

Horizontal & Vertical

Horizontal radiators can only be mounted with the heating element on the bottom. Vertical radiators can only be mounted with the heating element to the right :

Lean the radiator against the wall in the desired position. Lightly mark on the wall the position of the top brackets. Move the radiator and mark a vertical line on the marked points using a spirit level .

4. ...Continued

For vertical Radiators. Mark desired height of radiator on the vertical lines, Measure 100mm down from this mark . similarly measure down the vertical line and mark where the bottom of the radiator would be and make a mark 100mm upwards. Using a spirit level mark a short horizontal line across the 4 marks . Hold up wall plate (Part A) using vertical line as center of the plate and mark screw holes on the horizontal lines. These are the fixing points for the wall plates.

For Horizontal radiators Mark desired height of radiator on the vertical lines, Measure 80mm down from this mark. Measure down from the top mark to where the bottom of the radiator will be Measure 140mm up from this mark. Using a spirit level mark a short horizontal line across the 4 marks . Hold up wall plate (part A) using vertical line as center of the plate and mark screw holes on the horizontal lines. These are the fixing points for the wall plates.

5. Electrical Installation & Controls

PLEASE NOTE: This is an electric radiator and MUST be installed by a qualified electrician as the pilot wire needs to be connected to the mains supply.

To supply On/Off power to the radiator, an omnipolar switch with a minimum of 3mm distance between contacts must be employed.

This radiator is an electrical appliance & comes with the following features:

- Voltage-feed 230V 50Hz, 1ph
- Insulation Class II
- Protection degree IP24
- Length of electrical cable is 1200mm
- Wi-Fi electronic control.
- IRSAP Now app used to control & customise heating from your phone. A quick start guide and tutorials are all available on the app.

Technical Specifications

Materials:	Steel
Connections:	Electric, Fil-Pilote/Pilot Wire
Electric Power:	500 - 1800 Watts
Certification:	CE Certificate of Conformity
Packaging:	Wrapped in polyethylene & boxed.
Maximum Operating Temp.	70°C

Guarantees & Liabilities

This product is guaranteed for 10 years. As we are not the manufacturers of this product we will take all reasonable endeavours to make over to you the benefit of any warranty or guarantee given by the manufacturer.

The guarantees in all cases are subject to the products being installed in accordance with British and or European standards as well as these fitting instructions.

The guarantees in all cases are restricted to the free of charge replacement or repair of the failed product only. Our liability will under no circumstances extend beyond the repair or replacement of the product supplied by us. Claims for either labour in replacement or damage to property are not admissible. Any goods that are returned, in the event of a problem, will belong to us.

Terms & Conditions

All products must be inspected once removed from the packaging and you must notify us within 28 days of delivery of any scratches, blemishes or other damage. We will then agree appropriate action based on the information provided.

Imperfect radiators should therefore not be fitted and we will not accept responsibility for replacement of scratched or damaged radiators once they have been fitted. This includes any consequential loss or cost of fitting. If we are not notified within 28 days of the date on the signed delivery note then it will be deemed that we have fully complied with our obligations and claims will not be considered.

Failure to comply with any of the above may invalidate any claims. We recommend that after you check the product on delivery that it is stored in its packaging to prevent damage prior to installation, we cannot accept responsibility for items damaged after delivery.

For full details of our Terms and Conditions please visit www.radiatorsdirect.co.uk or call us on 01342 305555